



morphy richards

**3 Year
Guarantee***

*Upon registering your product
at morphyrichards.co.uk

BREW & BLEND Electric Milk Frother



Model No.

210003

User Manual

Please read and keep these instructions for future use





HEALTH AND SAFETY

The use of any electrical appliance requires the following common sense safety rules.

Please read these instructions carefully before using the product.

- This appliance can be used by children aged from 8 years and above if they have been given supervision or instruction concerning the use of the appliance in a safe way and if they understand the hazards involved.
- Children shall not play with the appliance.
- Cleaning and user maintenance shall not be made by children unless they are older than 8 and supervised.
- Keep the appliance and cord out of the reach of children aged less than 8 years.
- Appliances can be used by persons with reduced physical, sensory or mental capabilities or lack of experience and knowledge if they have been given supervision or instruction concerning use of the appliance in a safe way and understand the hazards involved.





HEALTH AND SAFETY

- This appliance is intended for household use only. It is not suitable for use in staff kitchen areas, in shops, offices and other working environments.
- This appliance is not intended to be operated on an extension cable or by means of an external timer or a separate remote control system.
- If the mains cable is damaged, it must be replaced by the manufacturer, its service agent or similarly qualified persons in order to avoid a hazard.
- **WARNING: The appliance must not be immersed for cleaning.**





HEALTH AND SAFETY

LOCATION

- Always locate your appliance away from the edge of the worktop.
- Ensure that the appliance is used on a firm, flat surface.
- Do not use the appliance outdoors or near water.
- **WARNING:** Do not place the appliance onto a metal tray or metal surface whilst in use.

MAINS CABLE

- Do not let the mains cable hang over the edge of the worktop where a child could reach it.
- Do not let the mains cable run across an open space e.g. between a low socket and a table.
- Do not let the cable run across a cooker or other hot area which might damage the cable.
- The mains cable should reach from the socket to the power base without straining the connections.

PERSONAL SAFETY

- **WARNING:** To protect against fire, electric shock and personal injury, do not immerse the cord, plug or appliance in water or any other liquid.

- **WARNING:** Misuse of appliance could cause personal injury.
- Unplug from the outlet before cleaning.
- Allow to cool before putting on or taking off parts and before cleaning.
- Do not move the milk frother while switched on.

OTHER SAFETY CONSIDERATIONS

- The use of appliances or tools not recommended or sold by Morphy Richards may cause fire, electric shock or injury.
- Do not use the appliance for any other use other than its intended purpose.
- Do not place the appliance on or near a hot gas or electric burner or in a heated oven.
- When using the unit, ensure the lid is in place properly before switching on.
- Do not remove the lid until the frother has stopped turning.
- Never fill your milk frother above the maximum fill line.
- **CAUTION:** To prevent damage to the appliance, do not use alkaline cleaning agents when cleaning. Use a soft cloth and detergent.



ELECTRICAL REQUIREMENTS

Check that the voltage on the rating plate of your appliance corresponds with your house electricity supply which must be AC. (Alternating Current). Should the fuse in the mains plug require changing, replace it with a fuse of the same rating as originally fitted.

WARNING: This appliance must be earthed.

PRODUCT OVERVIEW

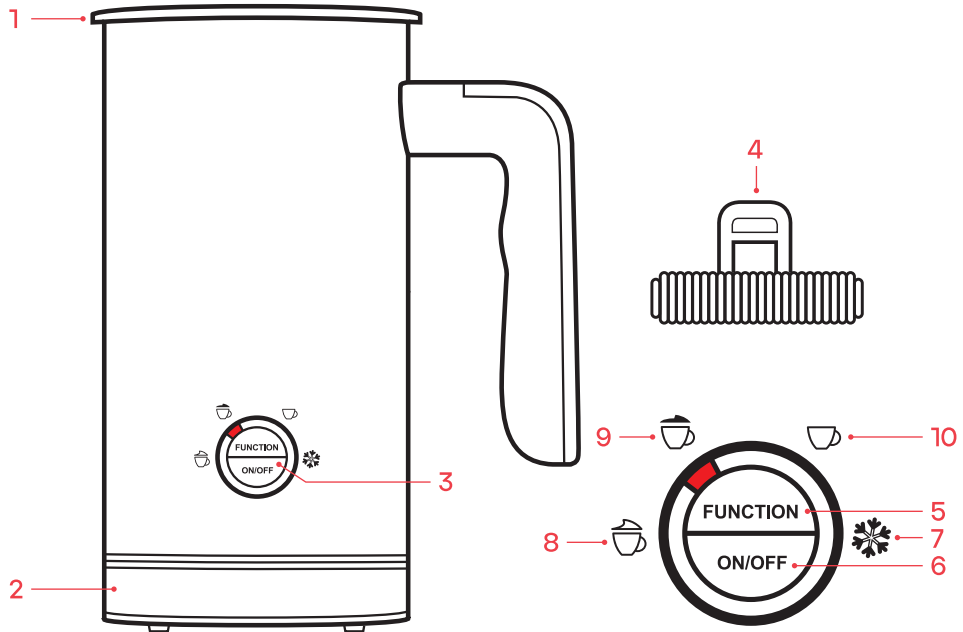

- | | |
|------------------------------|-------------------------------|
| 1. Lid | 6. On/Off Button |
| 2. Power Base | 7. Cold Froth Only |
| 3. Function & On/Off Control | 8. Warm Milk with Thick Froth |
| 4. Frother Attachment | 9. Warm Milk with Light Froth |
| 5. Function Button | 10. Warm Milk Only |





BEFORE FIRST USE

- Remove all packaging materials.
- Remove any stickers or labels from the appliance. Do not remove the rating label on the bottom of the appliance.
- Wash the inside of the milk frother using warm soapy water and a soft damp cloth. **DO NOT** use a scouring pad or abrasive material as this will mark the non-stick coating. Rinse and dry.

USING YOUR MILK FROTHER

- **DO NOT IMMERSE IN WATER OR WASH ANY OF THE PARTS IN THE DISHWASHER.**
- **DO NOT EXCEED THE MAXIMUM LEVEL INDICATORS.**

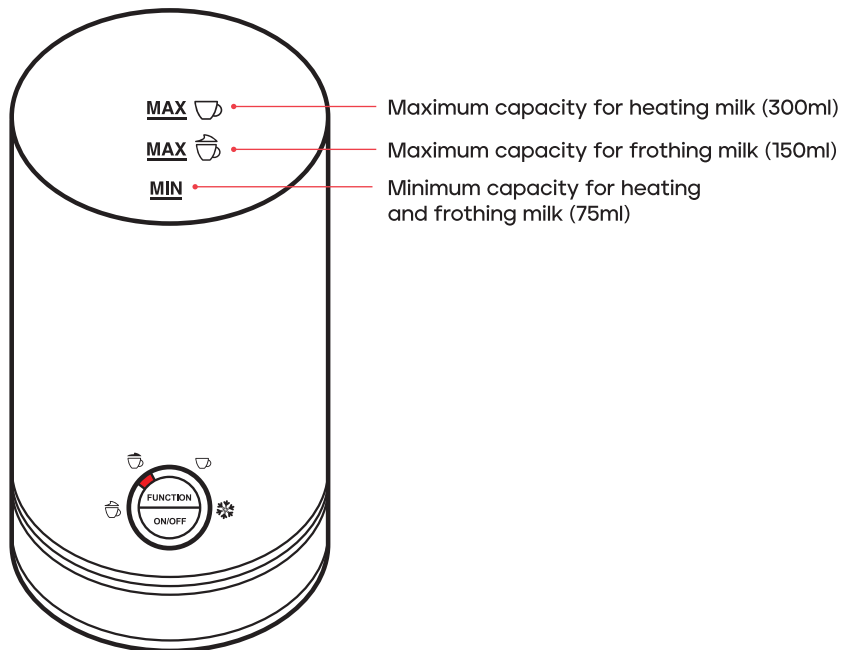



FUNCTIONS

WARM MILK WITH THICK FROTH

Note: To avoid the milk overflowing during frothing, the maximum amount is 150ml. The minimum amount is 75ml.

1. Place the appliance on a flat, level surface.
2. Remove the lid and attach the frother attachment onto the shaft on the bottom of the milk frother jug.
3. Fill the milk frother jug with the required amount of milk and replace the lid.
4. Connect the plug into a power socket.
5. Press the Function Button ONCE, the Warm Milk with Thick Froth indicator will illuminate. Then press the ON/OFF button, heating and frothing will begin.
6. It takes approximately 2½ minutes to heat and froth your milk to a temperature of 60°C. When the programme has finished, the frother will automatically switch off.

WARM MILK WITH LIGHT FROTH

Note: To avoid the milk overflowing during frothing, the maximum amount is 150ml. The minimum amount is 75ml.

1. Follow steps 1 - 4 of Warm Milk with Thick Froth.
2. Press the Function Button TWICE, the Warm Milk with Light Froth indicator will illuminate. Then press the ON/OFF button, heating and frothing will begin.
3. It takes approximately 2½ minutes to heat and froth your milk to a temperature of 60°C. When the programme has finished, the frother will automatically switch off.



FUNCTIONS

WARM MILK ONLY

Note: The maximum amount of milk for warming is 300ml. The minimum amount is 75ml.

1. Follow steps 1 - 4 of Warm Milk with Thick Froth.
2. Press the Function Button **THREE TIMES**, the Warm Milk only indicator will illuminate. Then press the ON/OFF button, heating will begin.
3. It takes approximately 2½ minutes to heat your milk to a temperature of 60°C. When the programme has finished, it will automatically switch off.

COLD FROTH

Note: To avoid the milk overflowing during frothing, the maximum amount is 150ml. The minimum amount is 75ml.

1. Follow steps 1 - 4 of Warm Milk with Thick Froth.
2. Press the Function Button **FOUR TIMES**, the Cold Froth only indicator will illuminate. Then press the ON/OFF button to start frothing.
3. It takes approximately 1½ minutes to froth your milk. When the programme has finished, it will automatically switch off.

Note: To cancel a programme mid-cycle, press the ON/OFF Button.



FUNCTIONS

POURING THE MILK

- For a perfect frothy drink, we recommend you separate the froth from the heated milk.
- To do this, use a spoon or spatula to retain the froth in the jug whilst pouring out the milk slowly. Add the froth on top afterwards.

FLAVOURED MILK DRINKS

- Follow the instructions for Cold Froth adding the recommended ratio of milkshake powder/syrup to the milk as per manufacturer's instructions.

HOT CHOCOLATE

- The product is limited to 60°C so that milk is not burnt. Therefore, it can be used for hot chocolate if you are satisfied to drink it at this temperature.
- Follow the instructions for Warm Milk with Light Froth adding the recommended ratio of hot chocolate powder/syrup to the milk as per manufacturer's instructions.

Note: The inside of your frother jug must be cleaned immediately after every use with warm soapy water and a soft cloth.

CAUTION

- To avoid milk burning to the base of the jug, wash it out between consecutive cycles and immediately after use.
- A minimum rest of 3 minutes is required between two consecutive cycles, or the safety-cut out will operate, and the lights will flash.
- Always disconnect the Milk Frother from the power supply when not in use.





CLEANING AND MAINTENANCE

Always disconnect the appliance from the power socket and allow it to cool down before cleaning.

- We recommend that you clean inside your frother jug immediately after every use with warm soapy water and a soft cloth. Do not use abrasive cleaning solutions or scouring pads as this can damage the non-stick coating.
- Remove the frother attachment and lid and wash in warm soapy water.
- Wipe down the outside with warm soapy water and a soft cloth. Do not use abrasive cleaners.
- NO PARTS OF THE FROTHER ARE DISHWASHER SAFE.
- DO NOT SUBMERGE THE FROTHER OR THE BASE IN WATER.

WARNING: Take care when cleaning not to get the electrical components wet.



COFFEE PREPARATION GUIDE

Your milk frother helps you to make a variety of coffee drinks helping you to create the coffee shop experience in your own home. The diagrams on this page are a simple guide showing you the percentage of ingredients that make up each of the drink types.



Espresso

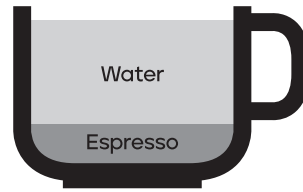

Americano

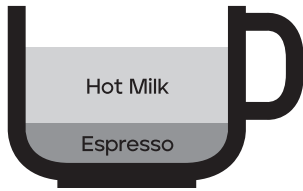

Flat White



Espresso Macchiato



Espresso con Panna

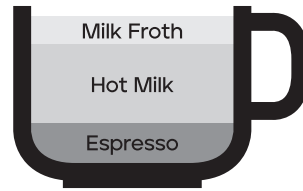

Caffé Latte

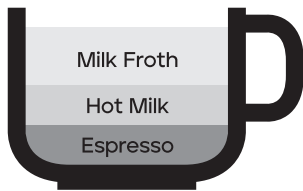

Cappuccino



Caffé Mocha



TROUBLESHOOTING

| Problem | Reason | Solution |
|------------------------|--|---|
| The unit isn't working | The unit isn't switched on | Check the unit is plugged in correctly and switched on |
| | Fuse in the plug has blown | Replace the fuse with a fuse of the same rating as originally fitted |
| | Mains power supply fault | Try a different plug mains socket |
| | Safety cut-out and all lights are flashing | Wash out the jug and allow to cool |
| Milk is not frothing | The frothing paddle isn't installed correctly | Empty the milk from the jug and re-position the frother attachment securely |
| | Milk is too warm | Use milk directly from the fridge |
| | Inside the jug and/or the frother attachment have milk residue on them | Clean the jug and frother attachment paddle according to Care & Cleaning instructions |
| | Different types of dairy milk and plant based milk can froth differently | Experiment to find your favourite result |





REGISTERING YOUR 3 YEAR GUARANTEE

Your standard 2 year guarantee is extended for an additional 1 year when you register the product within 28 days of purchase with Morphy Richards. If you do not register the product with Morphy Richards within 28 days, your product is guaranteed for 2 years.



To validate your 3 year guarantee, scan the QR code or register online at www.morphyrichards.co.uk

N.B. Each qualifying product needs to be registered with Morphy Richards individually. Please note that the 2 year guarantee is only available in the UK. Please refer to the 2 year guarantee for more information.

YOUR 2 YEAR GUARANTEE

It is important to retain the retailer's receipt as proof of purchase. Staple your receipt to the back cover for future reference.

Please quote the following information if the product develops a fault. These numbers can be found on the base of the product.

Model no.

Serial no.

All Morphy Richards products are individually tested before leaving the factory. In the unlikely event of any appliance proving to be faulty within 28 days of purchase, it should be returned to the place of purchase for it to be replaced. If the fault develops after 28 days and within 12 months of original purchase, you should contact the Helpline quoting Model number and Serial number on the product, or write to Morphy Richards at the address shown. You may be asked to return a copy of proof of purchase.

Subject to the exclusions set out below (see Exclusions), the faulty appliance will then be repaired or replaced as appropriate and dispatched usually within 7 working days of receipt.

If, for any reason, this item is replaced or repaired during the 2 year





REGISTERING YOUR 3 YEAR GUARANTEE

guarantee period, the guarantee on the new item will be calculated from the original purchase date. Therefore it is vital to retain your original till receipt or invoice to indicate the date of initial purchase.

To qualify for the 2 year guarantee, the appliance must have been used according to the instructions supplied.

The appliance is intended for domestic use only. Misuse or use for commercial or any other purpose will render the guarantee invalid.

Exclusions

Morphy Richards shall not be liable to replace or repair the goods under the terms of the guarantee where:

1. The fault has been caused or is attributable to accidental use, misuse, negligent use or used contrary to the manufacturer's recommendations or where the fault has been caused by power surges or damage caused in transit.
2. The appliance has been used on a voltage supply other than that stamped on the products.
3. Repairs have been attempted by persons other than our service staff (or authorised dealer).
4. The appliance has been used for hire purposes or non domestic use.
5. The appliance is second hand or refurbished.
6. Morphy Richards reserves the right not to carry out any type of servicing under the guarantee at its discretion.

This guarantee does not confer any rights other than those expressly set out above and does not cover any claims for consequential loss or damage. This guarantee is offered as an additional benefit and does not affect your statutory rights as a consumer. Morphy Richards products are intended for household use only. See usage limitations within the location safety instructions.

Disclaimer

Morphy Richards has a policy of continuous improvement in product quality and design. The company, therefore reserves the right to change the specification of its models at any time.





PRODUCT RECYCLING



For electrical products sold within the European Community, at the end of the electrical products useful life, it should not be disposed of with household waste.

Please recycle where facilities exist.

Check with your Local Authority or retailer for recycling advice in your country.

CONTACT US

If you are having a problem with your appliance, please contact our Helpline, as we are more likely to be able to help than the store you purchased the item from. Please have the product name, model number and serial number to hand when you contact us to help us deal with your enquiry quicker.

email: hello@morphyrichards.co.uk

www.morphyrichards.co.uk





CM210003MUK Rev1

morphy richards



@morphyrichardsuk #loveyourmorphy

morphyrichards.co.uk

Morphy Richards

9 Cabot Lane, Poole, Dorset, BH17 7BY, UK

