

Health and safety

The use of any electrical appliance requires the following common sense safety rules. **Please read these instructions carefully before using the product.**

- **WARNING: Misuse of the appliance could cause personal injury.**
- **WARNING: Disconnect from the mains supply before carrying out any routine maintenance.**
- This appliance can be used by children aged from 8 years and above and persons with reduced physical, sensory or mental capabilities, or lack of experience or knowledge, if they have been given supervision or instruction concerning the use of the appliance in a safe way and understand the hazards involved. Children shall not play with the appliance. Cleaning and user maintenance shall not be made by children without supervision.
- Keep the steam generator and its cord out of reach of children less than 8 years of age at all times.
- The steam generator must not be left unattended while it is connected to the supply mains.
- The steam generator must be used and rested on a stable surface.
- When placing the iron on the steam generator base or on its heel, ensure that the surface on which the heel or base is placed is stable.
- The steam generator is not to be used if it has been dropped, if there are visible signs of damage or it is leaking.
- The filling aperture may be opened during use, due to the design of the system.
- Do not operate with a damaged steam/supply cord or grommet, it must be replaced by the manufacturer, its service agent or similarly qualified person in order to avoid a hazard.

Exclusions

Morphy Richards shall not be liable to replace or repair the goods under the terms of the guarantee where:

1. The fault has been caused or is attributable to accidental use, misuse, negligent use or used contrary to the manufacturer's recommendations or where the fault has been caused by power surges or damage caused in transit.
2. The fault is caused by limescale build-up.
3. The cables are damaged due to wrapping too tightly or excessive kinking.
4. The appliance has been used on a voltage supply other than that detailed on the Rating Label.
5. Repairs have been attempted by persons other than our service staff (or authorised dealer).
6. The appliance has been used for hire purposes or non-domestic use.
7. The appliance is second hand.
8. Morphy Richards reserves the right not to carry out any type of servicing under the guarantee at its discretion.
9. This guarantee does not confer any rights other than those expressly set out above and does not cover any claims for consequential loss or damage. This guarantee is offered as an additional benefit and does not affect your statutory rights as a consumer. Morphy Richards products are intended for household use only. See usage limitations within the location safety instructions.

Other safety considerations

- Do not use any chemical detergents, perfumes, alcohol or descaler etc in water.
- Repairs to electrical appliances are only to be undertaken by trained personnel.
- Unprofessional repairs can be dangerous for users.
- Use only genuine Morphy Richards spare parts and accessories.
- The appliance must not be left unattended while connected to the supply mains.
- This appliance is intended for domestic use only. Misuse or use for commercial or any other purpose will render the guarantee invalid.

Location

- Do not use or keep this product outside.
- Do not store the appliance near hot surfaces eg. ovens or heating appliances.

Product Safety

- **WARNING: Always test on an inconspicuous area first. Never use on materials that can not resist high temperature, such as dralon, natural fur etc.**
- **WARNING: Misuse of the appliance could cause personal injury.**
- Never modify the appliance in any way.

Mains cable

- **WARNING: A damaged or severed mains cable fitted with a plug should never be connected to the mains supply. It must be destroyed, as a damaged cable becomes hazardous if connected to a power socket.**
- Do not let the mains lead come into contact with the hot soleplate of the iron.
- Do not allow the mains lead to become strained.

Personal safety

- **CAUTION - HOT:**
- **Burns can occur from touching hot parts, hot water or steam, or the iron rest plate.**
- **WARNING: Never direct steam at electrical components or fittings.**
- **If in doubt about the suitability of steam for cleaning an appliance, contact the appliance manufacturer for advice prior to cleaning.**
- **WARNING: Never touch the plug or cable with wet hands.**
- **WARNING: Nozzles and tools will be hot after use. Allow to cool before attempting to remove.**
- **WARNING: Do not discharge the steam towards people or animals. Danger of scalding.**
- **WARNING: Only ever press the Calc Clean function button when the iron is located on the Calc Clean Tray.**
- To protect against fire, electric shock and personal injury, do not immerse cord, plug or steam generator in water or other liquid.
- The plug should be removed from the wall socket after use, before cleaning, filling or changing the accessories, or carrying out user maintenance.

STEAM

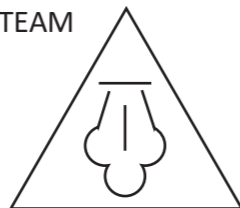

Electrical requirements

- Check that the voltage on the rating plate of your appliance corresponds with your house electricity supply which must be A.C. (Alternating Current).
- If the socket outlets in your home are not suitable for the plug supplied with this appliance, the plug should be removed by trained authorised personnel and the appropriate one fitted.
- **WARNING: This appliance must be earthed.**
- Should the fuse in the mains plug require changing, replace it with a fuse of the same rating as originally fitted.

Product Overview

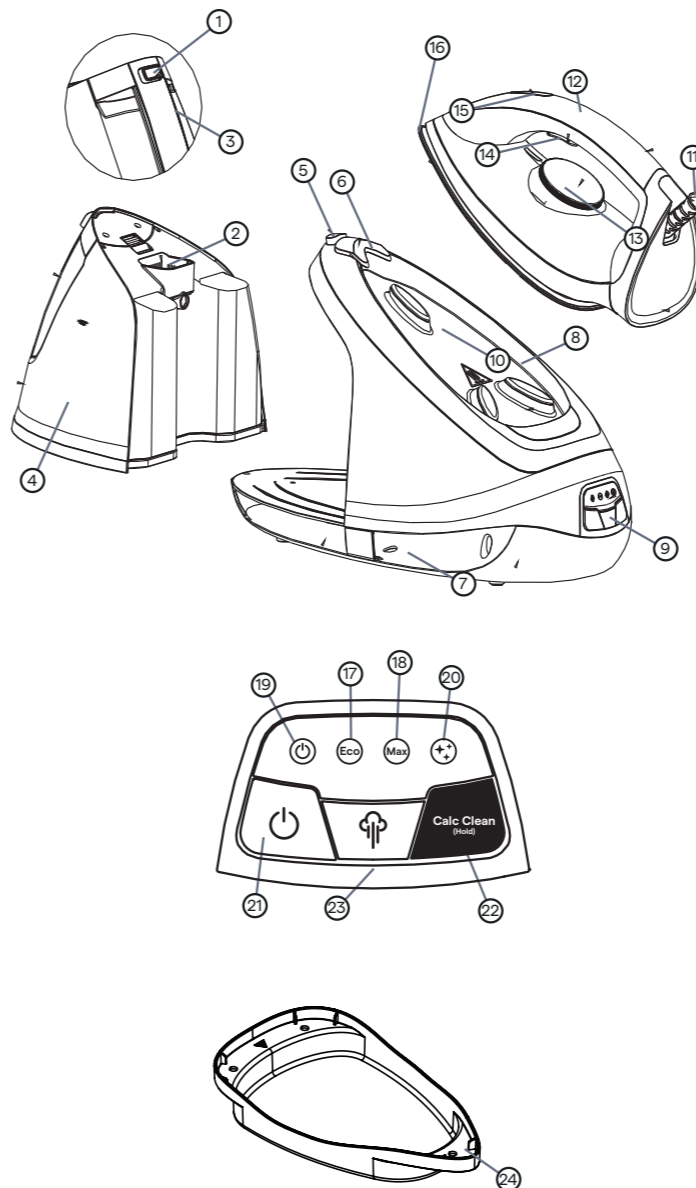

- | | | |
|----------------------------------|-------------------------------|-------------------------------|
| 1. Water Tank Release Button | 10. Iron Rest Plate | 20. Calc Clean Indicator |
| 2. Filling and emptying Aperture | 11. Cable Support | 21. On/Off Button |
| 3. Water Tank Handle | 12. Iron Handle | 22. Calc Clean Button |
| 4. Water Tank | 13. Temperature Dial | 23. Steam Rate Control Button |
| 5. Iron Lock and Unlock Buttons | 14. Steam Trigger | 24. Calc Clean Tray |
| 6. Iron Locking Hook | 15. Temperature Indicator | |
| 7. Cord Storage | 16. Soleplate | |
| 8. Base Unit | 17. ECO Steam Rate Indicator | |
| 9. Control Panel | 18. High Steam Rate Indicator | |
| | 19. Power Indicator | |

Location

Locate the steam generator horizontally on the iron rest plate of your ironing board (if large enough) or on a heat resistant stand at the same height as your ironing board or below it. Always ensure the steam generator is on a firm surface when ironing.

WARNING: Do not use the product on a surface which could be damaged by heat or steam such as a worktop or a polished wood surface.

Before First Use

Remove any protective cover from the soleplate (16) and the base unit (8). Unwind and straighten the power cord and steam supply cord.



Please read and keep these instructions for future use

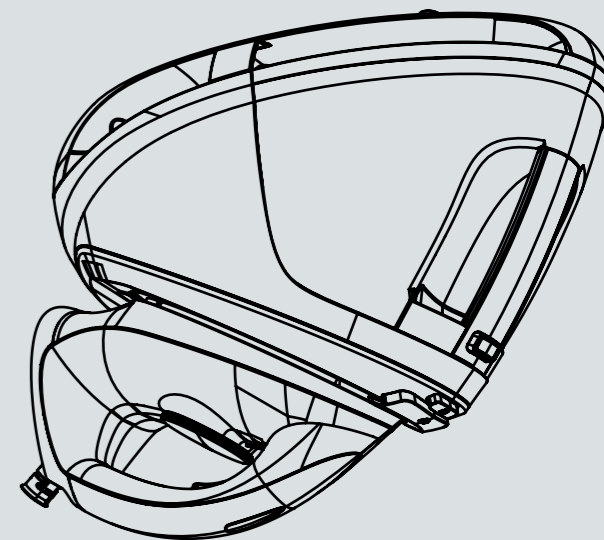

Easy Steam Black
1.8L Steam Generator

Morphy Richards

Contact us

If you are having a problem with your appliance or just need advice, contact us at Morphy Richards. Please have the product name, model number and serial number to hand, this will help us to deal with your enquiry quicker.

www.morphyrichards.co.uk

M
R.

UK
CA CE

www.morphyrichards.co.uk

RN333030MUK A3 Rev2

Using the Steam Generator

Remove the detachable water tank (4) by pressing the water tank release button (5) and pulling the water tank handle (3), fill with water through the filling aperture (2) to the Max fill line and replace the water tank.

Re-filling during use: If the water level is too low, the unit will not produce steam. If this happens, refill the detachable water tank (4) with water.

Plug in the appliance and press the on/off button (20), the power indicator (19) will illuminate and the steam rate default to ECO, the ECO steam rate indicator (17) will flash.

Select the Steam Rate: Press the steam rate control button (23) to switch between the High and ECO steam rates, one beep will be heard, and the corresponding steam rate indicator (17 or 18) will light solidly.

Select the Temperature: Turn the temperature dial (13) to set the iron temperature based on the garment/s to be ironed. Steam will only be produced when the iron temperature is set within the steam area of the temperature dial ie. at 2 Dot or above (see temperature dial below).

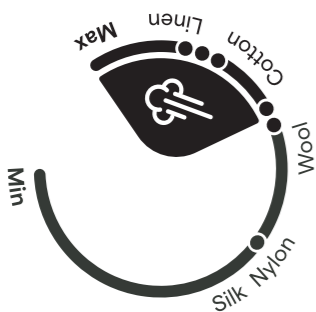

When the iron is heating up, the temperature indicator (17) will illuminate and when the iron has reached the selected temperature, the temperature indicator will go out. The temperature indicator will cycle on and off as the iron maintains the selected temperature during ironing.

Using the Iron: When the steam rate indicator (17 or 18) is lit solidly, Unlock the iron from the iron rest plate (5) the iron can now be lifted from the rest plate (see diagram below) and used for dry ironing.

To steam iron: Press and hold the steam trigger (14) to start the steam flow, release the steam trigger to stop the steam. The product will occasionally produce a pumping sound during steam ironing. This is normal and is caused by water being pumped from the water tank to the steam generator.

NOTE: We recommend for first time ironing that you iron over an old towel.

When you have finished ironing, locate the iron under the iron locking hook (6) place the iron on the iron rest plate and press down the iron lock button (5) to secure. Press and hold the on/off button (20) for about 2 seconds to switch off the steam generator. Disconnect the plug from the mains outlet.

Vertical steam is useful for removing creases from hanging clothes, curtains, upholstery, etc.

Hold the iron between 1cm and 2cm away from the item, press and hold the steam trigger (14).

To stop the steam, release the steam trigger.

Shot of steam

Shot of steam can be activated by pressing the steam trigger twice in quick succession.

Automatic power off

If the appliance is left idle/no steam produced, after 10 minutes the appliance will shut off automatically. To reactivate the appliance, press the on/off switch again.

Maintenance

To clean a coated soleplate

Do not use scouring powder or solution as this could cause damage to the coating.

If any man-made fibres fuse to the soleplate (7), set the iron at the MAX position and pass it over a clean piece of cotton to draw the deposit off the surface.

To clean the exterior

Allow the unit to cool and wipe over with a damp cloth and mild detergent, then wipe dry.

IMPORTANT

Using de-mineralised water.

To reduce limescale damage we recommend using deionised, distilled or demineralised water. This is particularly important if you live in a hard water area.

Never use battery topping up fluid or water containing any substances like starch, sugar, fragrant additives or defrosted water from a refridgerator.

Failure to adhere to the above guidelines will invalidate your guarantee.

Descaling

The appliance needs to be descaled when the Calc Clean indicator (20) flashes.

Fill water tank to MAX. Place the Calc Clean Tray (24) onto a flat, even heat resistant surface, position the soleplate(16) down onto the Calc Clean tray and turn the temperature dial to the “MAX” setting.

Press and hold the Calc Clean button (22) for 2 seconds. Stand back from the appliance when the buzzer sounds to avoid the steam being emitted from the appliance. The Calc Clean Indicator (20) will continue to flash throughout the cleaning cycle, which takes approximately 2 minutes. After the Calc Clean operation has finished, switch off, unplug and allow the iron to cool then, before re-use, wipe the iron soleplate with a damp cloth to remove any limescale residues that may have been ejected from the soleplate during the Calc Clean process.

Note: During the calc cleaning operation the iron will become covered in steam, do not move the iron to dry it, until it has cooled.

The Calc Clean tray will fill with very hot water during the Calc Clean operation, do not move the tray until the water has cooled.

NOTE: For the best cleaning results, always ensure that the temperature dial is set to “MAX”.

Emptying & Storing

Allow the appliance to cool.

Remove the detachable water tank and discard any remaining water. Re-attach the water tank to the base unit.

To store the steam supply hose and power cord: firstly, fold the steam supply hose in two and slot it along the cord storage groove (7), then fold and secure the power cord with the cable tie.

Avoid kinking of cables, particularly where they meet the base unit.

NOTE: When the iron is locked onto the iron rest plate the whole appliance can be lifted for carrying.

WARNING: Do not pull too tightly on the steam supply cord or on the cable support (11) when looping the power cord and steam supply cord. Damage to cables caused by wrapping too tightly will not be covered by the guarantee. Please see ‘Exclusions’.

Troubleshooting

1. No power or not heating up.
 - Check the fuse. Try a new fuse with the same rating.
 - Try a different appliance in the socket as it may be the socket that is at fault.
 - Check that the auto shut off has not operated.
 - Ensure the iron is switched on by pressing the On/Off power button.
 - Check the iron temperature dial is not set to minimum.
2. Overheating or not getting hot enough.
 - Allow the iron to reach temperature and stabilise for 1-2 minutes if it has just been plugged in or has just been woken up from auto shut off.
 - Ensure the temperature setting on the iron matches that of the garment being irons to avoid burning it.

3. Not steaming or poor steam.
 - There will be a short delay with a steam generator whilst water and steam are pumped and travels from the base to the iron.
 - Check that there is enough water in the tank.
 - If the iron’s auto shut off feature has activated, wake up the iron and allow it to reach temperature before using steam.
 - Check that the temperature dial is set to within the steam band (above 2-dots), otherwise the product will not produce any steam.
 - If the CALC CLEAN button is illuminated, perform a calc clean to clear away limescale inside the iron (refer to DESCALING section).

4. The product produces a pumping sound during steam ironing.
 - This is normal and is caused by water being pumped through the system. The pump is controlled by the unit automatically.

5. Dripping from the holes in the soleplate.
 - If the iron’s auto shut off feature has activated, wake up the iron and allow it to reach temperature before using steam.
 - Ensure to only use water without any additives or chemicals, otherwise it may damage the iron. It is best to use deionised water to avoid limescale build-up.

6. Tripping Electrics.
 - Try using a different socket.
 - Ensure there are no other appliances being used on the same set of sockets as the iron.

7. Steams continuously.
 - There may be some residual steam after releasing the steam trigger due to the long cords. This is normal and should diminish after a few seconds.

8. The CALC CLEAN indicator is illuminated.
 - It is time to descale the system. Follow the instructions under DESCALING to remove limescale.

Your 1 Year Guarantee

If you haven’t registered your product for the additional 12 months guarantee. It is important to retain the retailer’s receipt as proof of purchase. Staple your receipt to your instruction manual for future reference.

Please quote the Model no. Serial no. if the product develops a fault. These numbers can be found on the base of the product.

All Morphy Richards products are individually tested before leaving the factory. If in the unlikely event of any appliance proving to be faulty within 28 days of purchase, it should be returned to the place of purchase for it to be replaced.

If the fault develops after 28 days and within 12 months of original purchase, you should contact Morphy Richards at the website address shown below (see Contact Us). You may be asked to return a copy of proof of purchase.

Subject to the exclusions (see Exclusions), the faulty appliance will then be repaired or replaced as appropriate and dispatched usually within 7 working days of receipt.

If, for any reason, this item is replaced or repaired during the 1-year guarantee period, the guarantee on the new item will be calculated from original purchase date. Therefore, it is vital to retain your original purchase receipt or invoice to indicate the date of initial purchase.

To qualify for the 1-year guarantee, the appliance must have been used according to the instructions supplied.

Disclaimer

 Morphy Richards has a policy of continuous improvement in product quality and design. The company, therefore reserves the right to change the specification of its models at any time.

For electrical products sold within the European Community. At the end of the electrical products useful life, it should not be disposed of with household waste.

Please recycle where facilities exist. Check with your Local Authority or retailer for recycling advice in your country.